

ENERGY EFFICIENCY

Thermal Transmission Coefficient

Uw ≥ 0.81 (W/m²K)

Please consult typology, dimensions and glazing.

ACCOUSTIC INSULATION

Maximum glazing: **40 mm**

Maximum acoustic insulation: **Rw = 46 dB**

CATEGORIES ACHIEVED AT TEST CENTRE

Protection against atmospheric agents

Air permeability (EN 12207):

Class 4

Water tightness (EN 12208):

Class E1650

Wind resistance (EN 12210):

Class C5

Reference test 1.23 x 1.48 m / 1 Sash

Security Test: **PAS24**

Passed

Reference test 1.100 x 2.400 m / 1 sash

SECTIONS	Frame 70 mm Sash 70 mm	EXTRUSION ALLOY	6063 T-5
PROFILE THICKNESS	Window 1.9 mm	POLYAMIDE STRIP LENGTH	Polyamide 6.6 reinforced with 25% fiberglass: 35 mm
MAXIMUM DIMENSIONS	Standard solution Width (L) = 1.300 mm Height (H) = 2.400 mm HD Hinges (side hung) Width (L) = 1.200 mm Height (H) = 3.500 mm	GASKETS	EPDM triple gasket
MAXIMUM WEIGHT/SASH	160 Kg	FOAMS	Perimeter polyolefin foam in glazing rebate zone
Please consult maximum dimensions according to types.		OPENING POSSIBILITIES	INWARD Side hung, tilt and turn&tilt
FINISHES	Colour powder coating (RAL, mottled, rough...) According to Qualicoat >60 microns Wood effect powder coating According to Qualideco standard Anodized According to Ewwa Euras Standard Class 15 Optionally Class 20 and 25 Optionally bicoloured	CERTIFICATES	DTA certification from CSTB lab. Certification - 3204

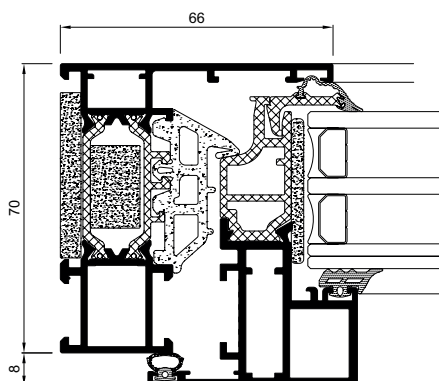

ENERGY EFFICIENCY

Thermal Transmission Coefficient
Uw ≥ 0.82 (W/m²K)

Please consult typology, dimensions and glazing.

ACCOUSTIC INSULATION

Maximum glazing: **55 mm**
Maximum acoustic insulation: **Rw = 44 dB**

CATEGORIES ACHIEVED AT TEST CENTRE

Protection against atmospheric agents

Air permeability (EN 12207:

Water tightness (EN 12208):

Wind resistance (EN 12210):

Reference test 1.23 x 1.48 m / 2 sashes

Class 4

Class E1800

Class C5

SECTIONS	Frame 70 mm Sash 78 mm
PROFILE THICKNESS	Window 1.5 mm
MAXIMUM DIMENSIONS	Width (L) = 1000 mm Height (H) = 1700mm
MAXIMUM WEIGHT/SASH	160 Kg

Please consult maximum dimensions according to types.

FINISHES	<p>Colour powder coating (RAL, mottled, rough...) According to Qualicoat >60 microns</p> <p>Wood effect powder coating According to Qualideco standard</p> <p>Anodized According to Ewwa Euras Standard Class 15 Optionally Class 20 and 25 Optionally bicoloured</p>
----------	--

EXTRUSION ALLOY	6063 T-5
POLYAMIDE STRIP LENGTH	Polyamide 6.6 reinforced with 25% fiberglass: 32-35 mm
GASKETS	EPDM triple gasket
FOAMS	Perimeter polyolefin foam in glazing rebate zone
OPENING POSSIBILITIES	INWARD Side hung, tilt and turn&tilt
CERTIFICATES	<p>DTA certification from CSTB lab.</p> <p>Certification - 3204</p>

